

## Cor-Galicia Premium Aluminium Timber System with thermal break

A development of the Cor Galicia Premium series which is a mixed composite system comprising of aluminium and timber with thermal break and has a 66.4 mm frame depth which maintains the use of standard hardware and offers the possibility of triple adjustment and front fixing.

It has a similar shape but with an improved thermal and acoustic performance over the previous system version and is about a more economic window to fabricate by simplifying this phase and reducing the necessary manufacturing time by between 15 to 20%.

It is made up of external aluminium profiles that are assembled with 14.6 & 16 mm polyamide strips that make up the thermal breaking zone and improves notably its thermal insulation and being able to reach minimum window transmission values of 1.1 (W/m<sup>2</sup>K).

The joining of the external aluminium frames and the internal timber mouldings can be carried out in two ways: by fixing independently with clips (this allows for the substitution of the mouldings and the possibility of other timber treatments that are different to those normally supplied) and by way of assembly using an EPDM gasket. In both cases, this assembly ensures a perfect absorption of the different material expansions.



# Cor-Galicia Premium Aluminium Timber System with thermal break

## Transmittance

Uw from 1,3 (W/m²K)

Please consult typology, dimensions and glass

## Acoustic insulation

Maximum glazing: 40 mm.(Sash)  
30 mm.(Fix)

Maximum acoustic insulation **Rw=40 dBA**

## Finishes

### Aluminium

Possibility of dual colour

Colour powder coating (RAL, mottled and rough)

Wood effect powder coating

Anti-bacterial powder coating

Anodized

### Interior timber:

American Oak, Sapelly, Mellis Pine and other timber options available on order

(all of which are treated with an ecological varnish that is without dissolvent and is satin and transparent).

## Categories achieved at test centre

Air permeability  
(EN 12207:2000): Class 4

Water tightness  
(EN 12208:2000): Class 9A

Wind resistance  
(EN 12210:2000): Class C5  
Reference test 1,23 x 1,48 m. 2 sashes



## Sections

Frame 66,4 mm.

Sash 85,3 mm.

## Profile thickness

Window 1,5 mm.

Door 1,6 mm.

## Polyamide strip length

Frame 14.8 mm. Sash 16 mm.

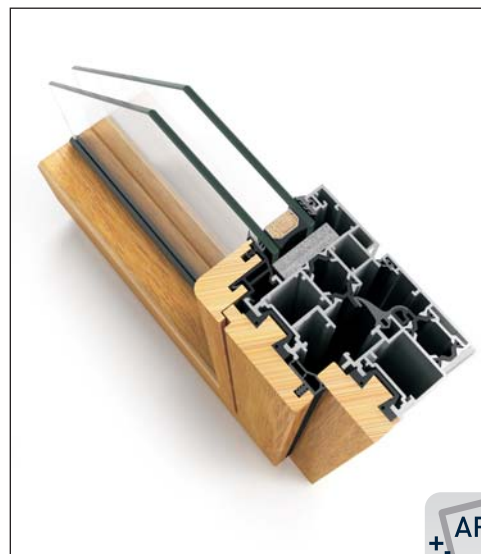
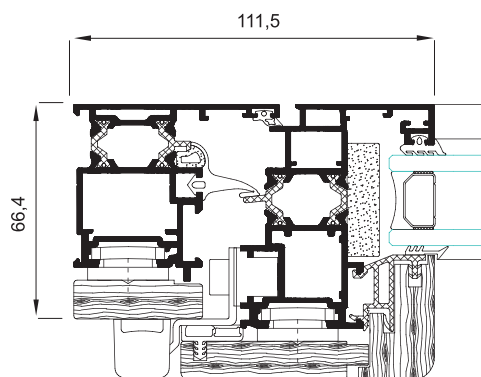

## Opening possibilities



**Open in:** practicable, turn-tilt parallel tilt, hinged.

## Maximum dimensions/sash

Width (L) = 1.400 mm.

Height (H) = 2.400 mm.

Please consult regarding maximum weight and dimensions according to types

## Maximum weight/sash

100 Kg.